

# Colin Ellis

Commercial

## TO LET



### Westborough, Scarborough YO11 1UN

A great opportunity to take on a fantastic sized unit in the busy town centre of Scarborough. Benefitting from close proximity to Scarborough Railway Station the unit is subject to heavy footfall all year round. The unit comprises of a sales area measuring approx. 1,076 sq.ft on the ground floor with a large storage area, kitchenette and WC facilities at basement level. A unique unit that would suit a variety of uses, viewing is highly recommended. New lease with terms to be agreed.

**£22,000 p.a.x**

49 Aberdeen Walk, Scarborough  
North Yorkshire YO11 1BD  
Tel: 01723 363565

[www.colinellis.co.uk](http://www.colinellis.co.uk)  
[kong.colinellis@btconnect.com](mailto:kong.colinellis@btconnect.com)

# Property Number – 111772

## LOCATION

From Scarborough Railway Station, cross the road heading towards the town centre proceeding down Westborough. The property is on the right-hand side.

## SALES AREA

62'9" x 20'4" [19.13m x 6.2m] MAXIMUM

Great sized sales area with large display windows to the front, double door entrance, counter, door leading to stairs to basement level.

## BASEMENT

On the basement level there is a sizable main storage area currently laid out with shelving, a small kitchenette area comprising of worktops and sink with room for basic kitchen appliances, to the rear is a WC. There is also a smaller secondary storage room.

## LEASE

New lease to be agreed direct with Landlord. Building Insurance and Service Charge costs can be made available upon request

## EPC RATING

TBC

## VIEWING

All viewings via Colin Ellis Property Services.

## COMMERCIAL DISCLAIMER

Unless otherwise stated, all prices and rentals quoted are exclusive of any VAT to which they may be subject. Specific enquires should be made of the vendor/landlord for clarification prior to entering into any arrangement or agreement. These particulars are a general outline only, for the guidance of prospective purchasers or tenants and do not constitute the whole or any part of an offer of contract. Colin Ellis Property Services cannot guarantee the accuracy of any description, dimensions references to condition, necessary permission for use and occupation and other details contained herein and prospective purchasers or tenants must not accept as statement of fact or representation and must satisfy themselves as to their accuracy. The reference to any plan, machinery, equipment, devices, fixtures, or fittings at the property shall not constitute a representation unless otherwise stated as to the state or condition or that it is capable of fulfilling its intended function. Prospective purchasers/tenants should satisfy themselves as the fitness of such items for their requirements. Colin Ellis Property Services will not be liable in negligence or otherwise nor anyone arising from the use of these particulars. No employee of Colin Ellis Property Services has any authority to make or give any representation or warranty or enter into any contract whatever in relation to the property.

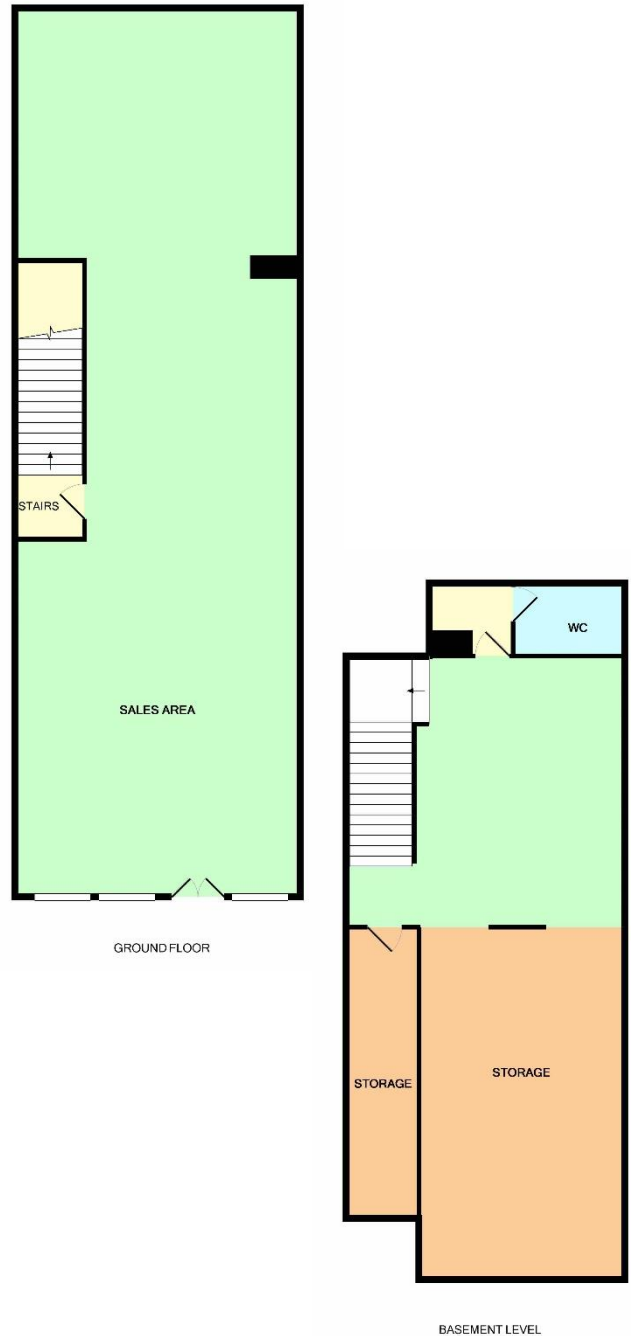

Whilst every attempt has been made to ensure the accuracy of the floor plan contained here, measurements of doors, windows, rooms and any other items are approximate and no responsibility is taken for any error, omission, or mis-statement. This plan is for illustrative purposes only and should be used as such by any prospective purchaser. The services, systems and appliances shown have not been tested and no guarantee as to their operability or efficiency can be given  
Made with Metropix ©2019



RESIDENTIAL & COMMERCIAL SALES  
MORTGAGE & HOME BUYER SURVEYS

PROPERTY MANAGEMENT  
RENT REVIEWS VALUATIONS FOR TAX